

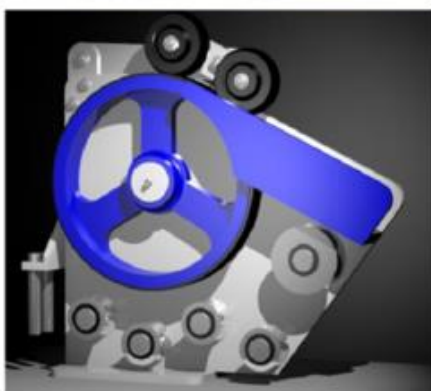

## Marine Equipment Catalogue

*Price list is pending – please contact Skadia Technologies for prices*

**2020-V6**

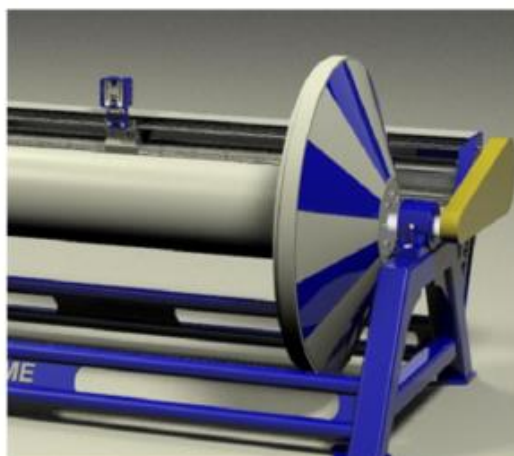

***Great tech for more  
sustainable fishing***



**CONTENTS**

Marine Equipment Catalogue .....	1
<b>Longline Equipment.....</b>	<b>3</b>
Longline Reels – Solid Core: SC800, SC1000, SC1200, SC1500, SC1800.....	3
Longline Shooter – LS30 Series.....	5
Longline Hauler – LH30 Series.....	6
Hydraulic Powerpacks .....	7
Deckwinch – 500 Series .....	8
Underwater Bait Setter.....	9
<b>Spare Parts .....</b>	<b>10</b>
Longline Reel Traveller Parts List.....	10
Longline Shooter Parts List.....	11
Longline Hauler Parts List.....	12
Hydraulic Powerpacks Parts List .....	13
Ancillary Parts List .....	14
<b>Order Form .....</b>	<b>15</b>

## Longline Equipment

### **LONGLINE REELS – SOLID CORE: SC800, SC1000, SC1200, SC1500, SC1800**

The SC longline reel range has been designed and manufactured utilising the latest technology along with many years of field development.

The main drum is constructed of marine grade aluminium with a solid aluminium core and a marine grade stainless steel shaft.

To increase the life span of the main bearings, coupling and drive motor, the main drum is balanced during manufacture. The frame is also constructed of marine grade aluminium. It is rigid, durable and compact in size, allowing for optimal free deck space.

Because of the materials used in the construction of the reel, it is considerably light but extremely strong.



#### Features

- Solid Core Aluminium Drum
- Marine Grade Aluminium Frame
- Radial Piston Hydraulic Motor
- Stainless Steel Shaft
- End Plate Covers
- Level Winder with Guard
- Stainless Steel Fasteners & Fixings
- Powder Coated

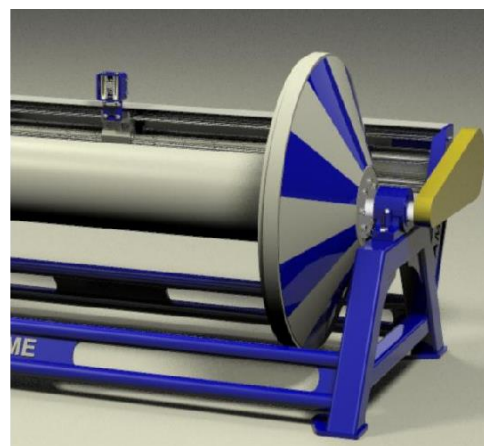

### Hydraulic Controls

To complement our range of longline equipment, we manufacture a range of hydraulic systems and hardware purpose built for the efficient operation of our products. These systems have been designed and developed around continued interaction with vessel owners, operators and maintenance personnel.

There are several systems available for the appropriate control of the torque, speed and stopping of our range of SC longline reels. The choice of these control systems is dependent on the customers preferred method of operation. Skadia Tech are also able to provide our customers a purpose built/designed hydraulic system which may entail primary deck winches, anchor winches, and hydraulic steering.

Skadia Tech equipment packages appeal to customers that require quality and efficiency with excellent value for money.

## SC800, SC1000, SC1200, SC1500, SC1800

...continuing from previous page

## Specifications &amp; Capacity

Code	RPM(max)			Required Pressure		3mm Line Capacity in Kilometres			
						Line Diameter	Line Diameter	Line Diameter	Line Diameter
SC800	200 RPM	50 L/M	11 kW	1500 PSI		39	53	28	23
SC1000	200 RPM	50 L/M	11 kW	1500 PSI		71	63	52	37
SC1200	200 RPM	50 L/M	11 kW	1500 PSI		95	84	70	50
SC1500	200 RPM	50 L/M	11 kW	1500 PSI		118	105	87	62
SC1800	200 RPM	50 L/M	11 kW	1500 PSI		140	126	105	75

## Dimensions &amp; Weight

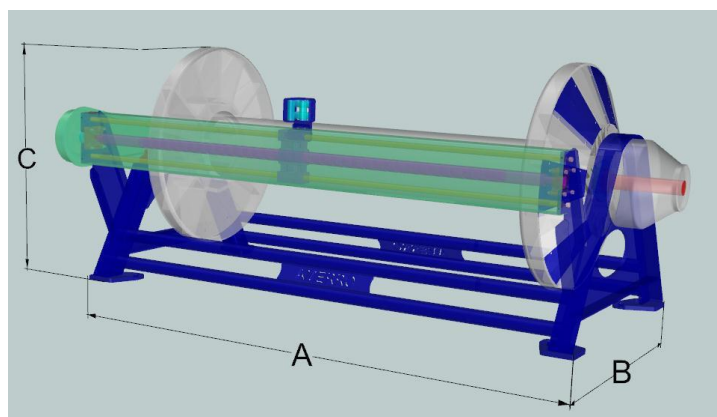

Code	Overall Dimensions			Weight without line approx.
	A – Length	B – Width	C – Height	
SC800	1403 mm	1095 mm	965 mm	385kg
SC1000	1665 mm	1210 mm	1120 mm	415kg
SC1200	1865 mm	1210 mm	1120 mm	495kg
SC1500	2165 mm	1210 mm	1120 mm	620kg
SC1800	2465 mm	1210 mm	1120 mm	745kg

## Code

## Description

## List Price

SC800

Longline Reel SC800 Series

A\$xx,xxx.00 exclusive GST

SC1000

Longline Reel SC1000 Series

A\$xx,xxx.00 exclusive GST

SC1200

Longline Reel SC1200 Series

A\$xx,xxx.00 exclusive GST

SC1500

Longline Reel SC1500 Series

A\$xx,xxx.00 exclusive GST

SC1800

Longline Reel SC1800 Series

A\$xx,xxx.00 exclusive GST

**LONGLINE SHOOTER – LS30 SERIES**

The LS30 Longline Shooter has been designed and manufactured with the latest technology and years of field development.

Capable of setting monofilament line from the longline reel at a rate equal to or faster than the vessel's speed enabling either deep or shallow water line setting.

Construction is of marine grade aluminium and 316 stainless steel, enabling the shooter to withstand the harsh marine environment. The speed, tension and slip of the line can be controlled via the hydraulic motor, shooter control manifold and adjustable tension wheel.

**Features**

- Marine Grade Aluminium Frame
- Hydraulic Motor
- Flow Control & Pressure Relief Valve
- Stainless Steel Rollers
- Adjustable Tension Wheel
- Marine Grade Aluminium Wheel
- Stainless Steel Fasteners & Fixings
- Powder Coated

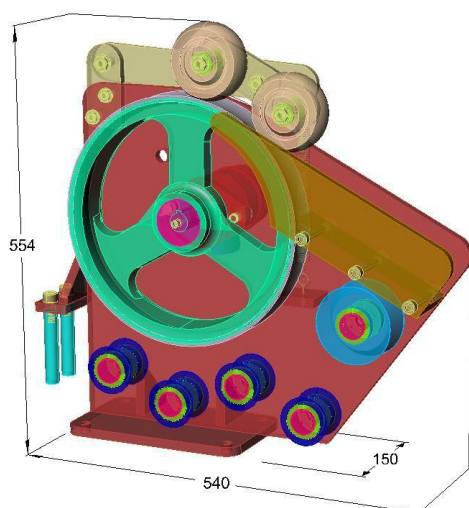
**Overall Dimensions****Specifications**

- RPM (max): 600 RPM
- Flow rate: 30 L/PM

**Bolt down pattern:**

4x 14mm holes at 110mm x 210mm

**Code:** LS30  
**Description:** Longline Shooter LS30  
**List Price:** A\$ x,xxx exclusive GST



**LONGLINE HAULER – LH30 SERIES**

The LH30 Longline Hauler has been manufactured for its ease of operation and robust design. Construction is of marine grade aluminium and 316 stainless steel, enabling the hauler to withstand the harsh marine environment.

The speed, tension and slip of the line can be controlled via the hydraulic motor, hauler control manifold and adjustable tension wheel.

**Features**

- Marine Grade Aluminium Frame
- Hydraulic Motor
- Flow Control & Pressure Relief Valve
- Stainless Steel Rollers
- Adjustable Tension Wheel
- Marine Grade Aluminium Wheel
- Stainless Steel Fasteners & Fixings
- Powder Coated

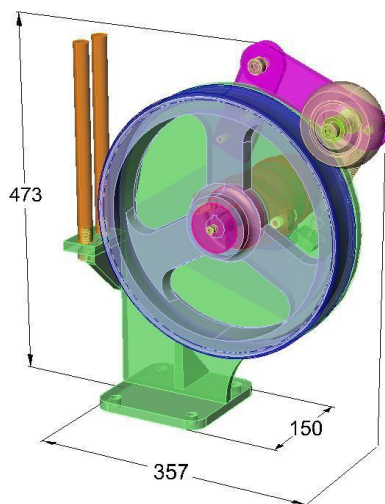
**Overall Dimensions****Specifications**

- RPM (max): 600 RPM
- Flow rate: 30 L/PM

**Bolt down pattern:**

4x 14mm holes at 110mm x 110mm

**Code:** LH30  
**Description:** Longline Hauler LH30 Series  
**List Price:** A\$ x,xxx exclusive GST

## HYDRAULIC POWERPACKS

The Skadia Tech Powerpack range has been designed for use with the Skadia Tech Longline Reels, Shooters, Haulers and Winches but can also be used on many other applications.

There are four models in the range which include the PP30, 32 litre per minute/4kW model, PP 50, 32 litre per minute/5.5 kW model, the PP 200, 50 litre per minute/11kW and the PPT 200 50/32 litre per minute /15kW tandem model.

Each Powerpack includes an oil reservoir unit and an electric motor unit. The oil reservoir unit consists of an aluminium hydraulic oil tank, hydraulic oil filter, inspection hatch and temperature / level gauge. The electric motor unit comprises of an electric motor, pump, coupling and bell housing. To accommodate the harsh marine environment, the tanks are manufactured from aluminium with 316 stainless steel fasteners.

### Features

- Marine Grade Aluminium Tank
- 40L, 50L & 200L Oil Reservoir Models
- CMG Electric Motor
- Oil Filters
- Temperature / Level Gauge
- Pump
- Coupling
- Bell Housing
- Stainless Steel Fasteners & Fixings
- Powder Coated



### Overall Dimensions & Weight

Code	'A'	'B'	'C'
PP30	400	747	410
PP50	400	847	510
PP200	840	695	980
PP200T	840	695	980

### Specifications

Reservoir	Voltage	Input Power	Litre per minute
40l	415V	4kW	32
50l	415V	5.5kW	32
200l	415V	11kW	50
200l	415V	11kW	82

PP200  
PP200T

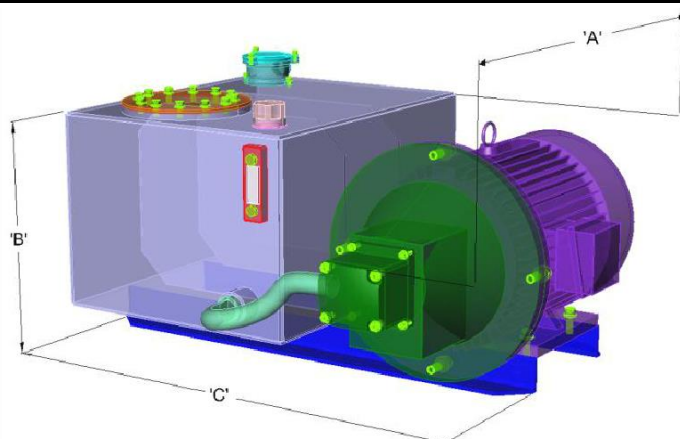

PP30  
PP50

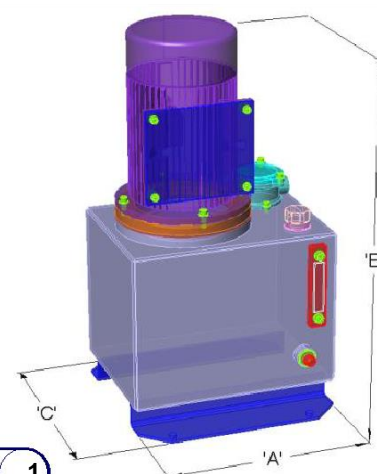

Code	Description	List Price
PP30	32/4kW Hydraulic Powerpack	A\$ X,xxx.00 exclusive GST <b>1</b>
PP50	32/5.5kW Hydraulic Powerpack	A\$ X,xxx.00 exclusive GST <b>2</b>
PP200	50/11kW Hydraulic Powerpack	A\$ X,xxx.00 exclusive GST <b>3</b>
PP200T	50-32/15kW Tandem Powerpack	A\$ X,xxx.00 exclusive GST <b>4</b>

**DECKWINCH – 500 SERIES**

The DW500 Deck Winch is designed primarily for the rapid raising and lowering of loads. Being compact in design and having a maximum lift of 500kg it is a very versatile deck winch.

The winch has a drum capable of handling either wire or rope and its mounting position is dependent on deck layout, but may be on deck, mast base or boom mounted.

A fail safe multi-disc static brake has also been installed on the winch, it is spring applied and hydraulically released. Construction is of marine grade aluminium enabling the deck winch to withstand the harsh marine environment.

**Features**

- Double End Bearing Supports
- Marine Grade Aluminium Frame
- 500kg Lifting Capacities
- Compact and Strong in Design
- Multi-disc Static Brake
- Marine Grade Aluminium Drum
- Stainless Steel Shaft
- Powder Coated

**Specifications**

- RPM (max): 160 RPM
- Flow rate: 25 L/PM
- Pressure: 2400 PSI

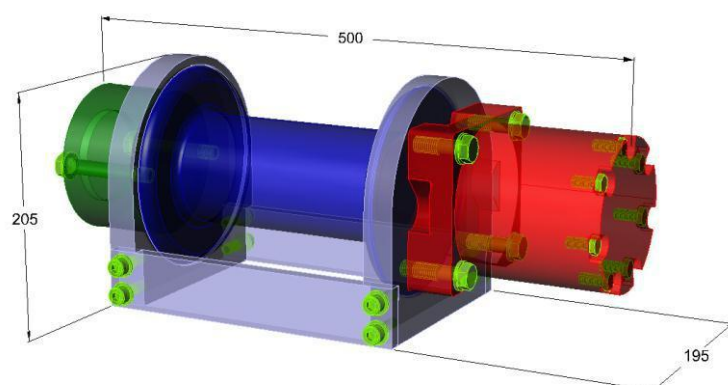
**Overall Dimensions**

**Code:** DW500  
**Description:** Deck Winch DW500  
**List Price:** A\$ x,xxx exclusive GST



## Underwater Bait Setter

The Underwater Bait Setter sets baited hooks by stealth. This stops albatrosses and petrels seeing baits going overboard and has been proven to eliminate unwanted seabird bycatch.

Cycle time and hook release depth are adjustable and selected using the wheelhouse control unit.

The Underwater Bait Setter has been extensively tested on shallow set surface longliners operating at around 1000-1500 hooks per set. It is mounted on the stern of the vessel adjacent to the main line and hydraulics can be run directly off the main engine or alternatively with a stand-alone powerpack.

Trials are currently in train to adapt the Bait Setter to suit deep set vessels setting 3,000 to 4,000 hooks per set.



Cycle Time (Sec)	5	6	7	8	9	10
Depth (m)	4.4	5.4	6.3	7.3	8.2	9.2
Number of hooks per 5-hour set	3600	3000	2571	2250	2000	1800

**Code:** UBS100  
**Description:** Underwater Bait Setter  
**Buy price:** A\$X exclusive GST  
**Lease price:** A\$X exclusive GST (monthly)



Contact Skadia Tech for a quote on installation and freight costs

## Spare Parts

### LONGLINE REEL TRAVELLER PARTS LIST

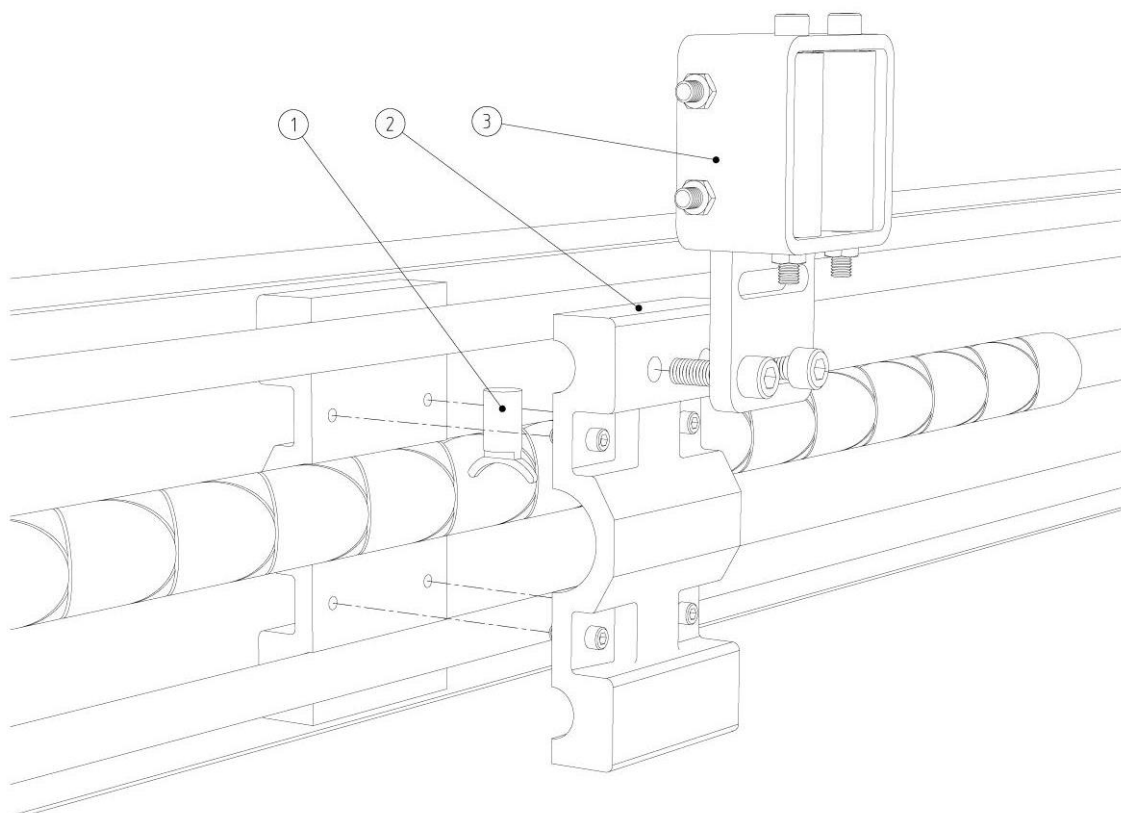

This mechanism is universal to suit Longline Reels SC1000, SC1200, SC1500 and SC1800.

**Code:** ASK101  
**Description:** Line Guide Knuckle  
**List Price:** A\$ XX.00 exclusive GST

1

**Code:** AAX101  
**Description:** Line Guide Block  
**List Price:** A\$ XXX.00 exclusive GST

2

**Code:** AST101S  
**Description:** Line Guide Roller Traveller  
**List Price:** A\$ XXX.00 exclusive GST

3

This model has stainless steel bearings in the rollers.

**Code:** AST101H  
**Description:** Line Guide Roller Traveller  
**List Price:** A\$ XXX.00 exclusive GST

3

This model has high tensile steel bearings in the rollers.

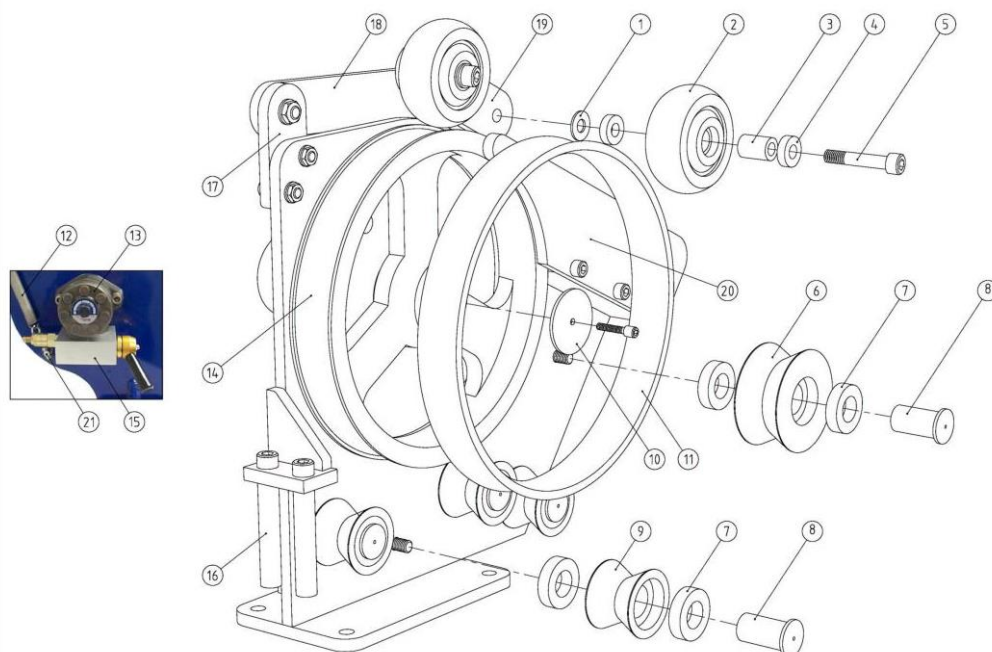
**LONGLINE SHOOTER PARTS LIST**

<b>Code</b>	<b>Description</b>	<b>List Price</b>
<b>ASS101</b>	Idler Wheel Bearing Shim	A\$ X.20 exclusive GST <b>1</b>
<b>ARW101</b>	Idler Wheel	A\$ XX.00 exclusive GST <b>2</b>
<b>ASS102</b>	Idler Wheel Bearing Spacer	A\$ XX.00 exclusive GST <b>3</b>
<b>SR8RS</b>	Idler Wheel S/S Bearing	A\$ XX.00 exclusive GST <b>4</b>
<b>ASN 101</b>	Idler Wheel Pin	A\$ XX.50 exclusive GST <b>5</b>
<b>ASR101</b>	Guide Roller (Large)	A\$ XXX.00 exclusive GST <b>6</b>
<b>SS6005RS</b>	Guide Roller Bearings	A\$ XX.00 exclusive GST <b>7</b>
<b>ASN102</b>	Guide Roller Pin	A\$ XX.00 exclusive GST <b>8</b>
<b>ASR102</b>	Guide Roller (Small)	A\$ XXX.00 exclusive GST <b>9</b>
<b>ASS103</b>	Drive Wheel Retaining Plate	A\$ XX.00 exclusive GST <b>10</b>
<b>AAW101R</b>	Drive Wheel Rubber Belt	A\$ XX.00 exclusive GST <b>11</b>
<b>ASV173</b>	S/S Tension Spring	A\$ XX.00 exclusive GST <b>12</b>
<b>DMP50A2.25</b>	Danfoss Hydraulic Motor	A\$ XXX.00 exclusive GST <b>13</b>
<b>AAW101</b>	Drive Wheel	A\$ XXX.00 exclusive GST <b>14</b>
<b>HYT531</b>	Hydraulic Flow Control Valve	A\$ XXX.00 exclusive GST <b>15</b>
<b>ASS104</b>	Shooter Line Guide Bar	A\$ XX.00 exclusive GST <b>16</b>
<b>ASS105</b>	Shooter Pivot Arm	A\$ XX.00 exclusive GST <b>17</b>
<b>ASS106</b>	Shooter Extension Bar	A\$ XX.00 exclusive GST <b>18</b>
<b>ASS107</b>	Idler Wheel Mount	A\$ XX.00 exclusive GST <b>19</b>
<b>ASS108</b>	Shooter Guide Plate	A\$ XX.00 exclusive GST <b>20</b>
<b>ASS109</b>	Spring Mount	A\$ XX.00 exclusive GST <b>21</b>

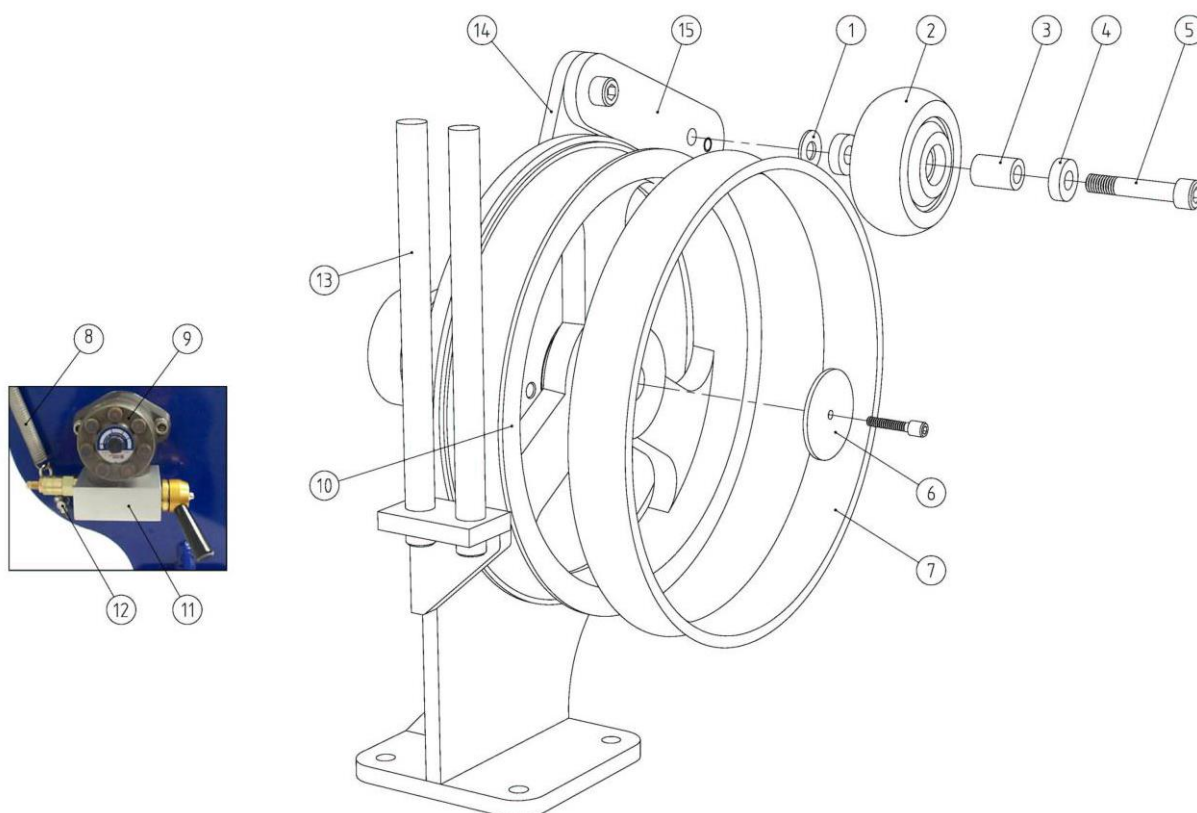
**LONGLINE HAULER PARTS LIST**

<b>Code</b>	<b>Description</b>	<b>List Price</b>
<b>ASS101</b>	Idler Wheel Bearing Shim	A\$ XX.20 exclusive GST <b>1</b>
<b>ARW101</b>	Idler Wheel	A\$ XX.00 exclusive GST <b>2</b>
<b>ASS102</b>	Idler Wheel Bearing Spacer	A\$ XX.00 exclusive GST <b>3</b>
<b>SR8RS</b>	Idler Wheel S/S Bearing	A\$ XX.00 exclusive GST <b>4</b>
<b>ASN 101</b>	Idler Wheel Pin	A\$ XX.50 exclusive GST <b>5</b>
<b>ASS 103</b>	Drive Wheel Retaining Plate	A\$ XX.00 exclusive GST <b>6</b>
<b>AAW101R</b>	Drive Wheel Rubber Belt	A\$ XX.00 exclusive GST <b>7</b>
<b>ASV173</b>	S/S Tension Spring	A\$ XX.00 exclusive GST <b>8</b>
<b>DMP50A2.25</b>	Danfoss Hydraulic Motor	A\$ XXX.00 exclusive GST <b>9</b>
<b>AAW101</b>	Drive Wheel	A\$ XXX.00 exclusive GST <b>10</b>
<b>HYT531</b>	Hydraulic Flow Control Valve	A\$ XXX.00 exclusive GST <b>11</b>
<b>ASS109</b>	Spring Mount	A\$ XX.00 exclusive GST <b>12</b>
<b>ASH101</b>	Hauler Line Guide Bar	A\$ XX.00 exclusive GST <b>13</b>
<b>ASH102</b>	Hauler Pivot Arm	A\$ XX.00 exclusive GST <b>14</b>
<b>ASH103</b>	Hauler Extension Arm	A\$ XX.00 exclusive GST <b>15</b>

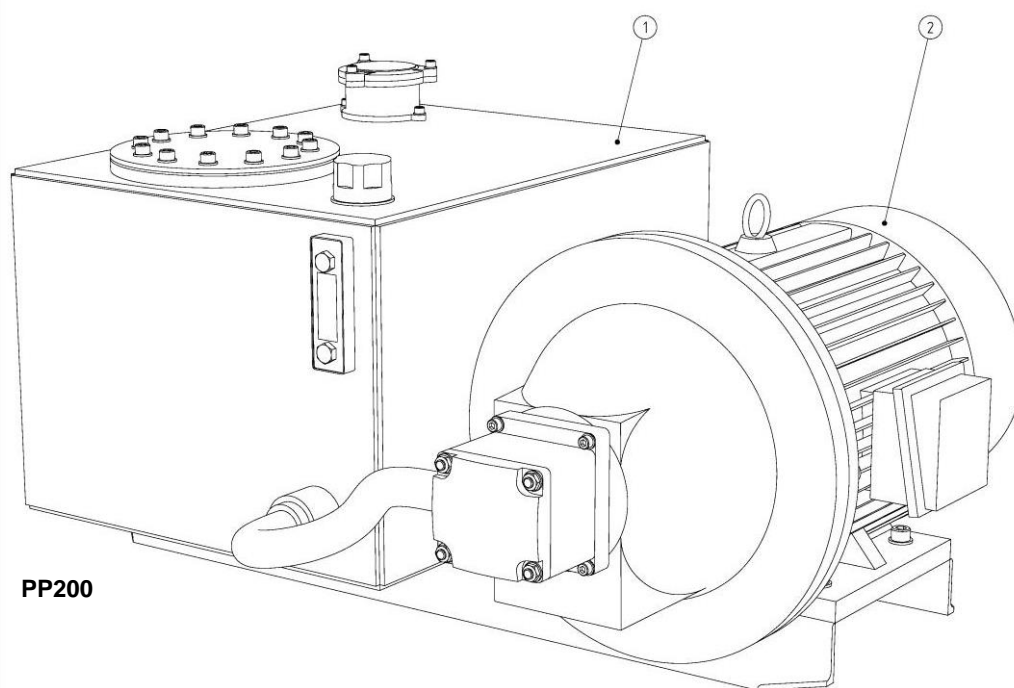
**HYDRAULIC POWERPACKS PARTS LIST****PP200****32LpM/4kW Hydraulic Powerpack**

<b>PP30</b>	32/5.5kW Hydraulic. Powerpack	A\$ X,XXX.00 exclusive GST
-------------	-------------------------------	----------------------------

Code	Description	List Price
ACU111	40L Oil Reservoir Unit	A\$ X,XXX.00 exclusive GST 1
ACU112	415V / 4kW Electric Motor Unit	A\$ X,XXX.00 exclusive GST 2

**50LpM/5.5kW Hydraulic Powerpack**

<b>PP50</b>	32/5.5kW I Hydraulic Powerpack	A\$ X,XXX.00 exclusive GST
-------------	--------------------------------	----------------------------

Code	Description	List Price
ACU121	50L Oil Reservoir Unit	A\$ X,XXX.00 exclusive GST 1
ACU122	415V / 5.5kW Electric Motor Unit	A\$ X,XXX.00 exclusive GST 2

**200LpM/11kW Hydraulic Powerpack**

<b>PP200</b>	50/11kW I Hydraulic Powerpack	A\$ X,XXX.00 exclusive GST
--------------	-------------------------------	----------------------------

<b>PP200T</b>	50-32/15kW Tandem Powerpack	A\$ X,XXX.00 exclusive GST
---------------	-----------------------------	----------------------------

Code	Description	List Price
ACU131	200L Oil Reservoir Unit	A\$ X,XXX.00 exclusive GST 1
ACU132	50/11kW Electric Motor Unit	A\$ X,XXX.00 exclusive GST 2
ACU132T	50-32/15kW Tandem Motor Unit	A\$ X,XXX.00 exclusive GST 2



**ANCILLARY PARTS LIST**

<b>IM250H1A2</b>	250cc H1 A2 Intermot Hydraulic Motor	A\$	X,XXX.00 exclusive GST	<b>1</b>
<b>IM250H2A2</b>	250cc H2 A2 Intermot Hydraulic Motor	A\$	X,XXX.00 exclusive GST	<b>2</b>
<b>RE100704</b>	RE100704 White Hydraulic Motor	A\$	XXX.00 exclusive GST	<b>3</b>
<b>AHV121</b>	Directional Control Valve	A\$	X,XXX.00 exclusive GST	<b>4</b>
<b>75285</b>	Oil Cooler 1¼" BSP	A\$	XXX.00 exclusive GST	<b>5</b>
<b>AHV181</b>	Hydraulic Brake Valve	A\$	XXX.00 exclusive GST	<b>6</b>
<b>AHU101</b>	Longline Speed Control Unit	A\$	XXX.00 exclusive GST	<b>-</b>



**Order Form**

<b>Code</b>	<b>Item Description</b>	<b>Qty</b>	<b>List Price Exclusive GST</b>	<b>Total Price Exclusive GST</b>
		<input type="text"/>	A\$	A\$
		<input type="text"/>	A\$	A\$
		<input type="text"/>	A\$	A\$
		<input type="text"/>	A\$	A\$
		<input type="text"/>	A\$	A\$
		<input type="text"/>	A\$	A\$
		<input type="text"/>	A\$	A\$
		<input type="text"/>	A\$	A\$
		<input type="text"/>	A\$	A\$
		<input type="text"/>	A\$	A\$
		<input type="text"/>	A\$	A\$
		<input type="text"/>	A\$	A\$
		<input type="text"/>	A\$	A\$
		<input type="text"/>	A\$	A\$
		<input type="text"/>	A\$	A\$

**Please Note:**

- Delivery/Freight charges are not included in list price.
- Prices may change without prior notice.

<b>Subtotal</b>	A\$	<input type="text"/>
<b>+10% GST</b>	A\$	<input type="text"/>
<b>TOTAL</b>	A\$	<input type="text"/>

**Company details for shipping**

Contact Name: .....

Company: .....

Address: .....

Suburb/Town: ..... Country: .....

State/Province: ..... Zip/Postal Code: .....

Phone: ..... Fax: .....

Email: ..... Date: .....

**Payment details**

☐ Cheque for \$ ..... payable to: Skadia Technologies

☐ Please charge my credit card:

☐ Visa    ☐ MasterCard    ☐ Bankcard    ☐ Amex

Card No.:

Signature ..... Expiry date ...../.....

Cardholder's name (please print) .....